

Cat[®] B25 Phone

User manual

Thank you for purchasing a
Cat B25 mobile phone

Brief introduction

Thank you for choosing the Cat B25 GSM cellular phone. You'll find details of the great features of the phone in this manual. The B25 is waterproof IPX7, dustproof IP6X, The phone is rugged enough to withstand a drop of 2.0m onto a hard surface. It also supports **FM radio, Bluetooth, MMS, LED Torch, Extra Long Battery Life.**

Please ensure you read the Important Product Information Guide at the end of this user manual prior to using the product

Legal Notice

© 2012 Caterpillar

CAT, CATERPILLAR, their respective logos, "Caterpillar Yellow," "Caterpillar Corporate Yellow," as well as corporate and product identity used herein, are trademarks of Caterpillar and may not be used without permission.

No part of this document may be reproduced or transmitted in any form or by any means without prior written consent of Caterpillar Inc.

The product described in this manual may include copyrighted software and possible licensors. Customers shall not in any manner reproduce, distribute, modify, decompile, disassemble, decrypt, extract, reverse engineer, lease, assign, or sublicense the said software or hardware, unless such restrictions are prohibited by applicable laws or such actions are approved by respective copyright holders under licenses.

Notice

Some features of the product and its accessories described herein rely on the software installed, capacities and settings of local network, and may not be activated or may be limited by local network operators or network service providers. Thus the descriptions herein may not exactly match the product or its accessories you purchase.

The manufacturer reserves the right to change or modify any information or specifications contained in this manual without prior notice or obligation.

The manufacturer is not responsible for the legitimacy and quality of any products that you upload or download through this mobile phone, including but not limited to the text, pictures, music, movies, and non-built-in software with copyright protection. Any consequences arising from the installation or usage of the preceding products on this mobile phone shall be borne by yourself.

NO WARRANTY

The contents of this manual are provided "as is". Except as required by applicable laws, no warranties of any kind, either express or implied, including but not limited to, the implied warranties of merchantability and fitness for a particular purpose, are made in relation to the accuracy, reliability or contents of this manual.

To the maximum extent permitted by applicable law, in no case shall the manufacturer be liable for any special, incidental, indirect, or consequential damages, or lost profits, business, revenue, data, goodwill or anticipated savings.

Import and Export Regulations

Customers shall comply with all applicable export or import laws and regulations and will obtain all necessary governmental permits and licenses in order to export, re-export or import the product mentioned in this manual including the software and technical data therein.

Contents

Introduction

1 Getting Started

1.1 Battery

1.2 Removing and installing the battery

1.3 Charging the battery

2 Connecting to the network

2.1 SIM card

2.2 Installing and removing the SIM card

2.3 Installing and removing the memory card

2.4 Switching on/off the device

2.5 Unlocking the SIM card

2.6 Unlocking the device

2.7 Connecting to the network

3 Basic Features

3.1 Coverage

3.2 Making DDD

7.2.1 Enter telephone number-by-number keys.

7.2.2 Dialing an extension number

3.3 Making IDD

3.4 Dialing the number in the list

3.5 Making an emergency call

3.6 Answering a call

3.7 Call history

4 Multimedia

4.1 Camera

4.2 Image viewer

4.3 Video recorder

4.4 Video player

4.5 Photo editor

4.5.1 Photo artist

4.5.2 Image tiles

4.6 Audio player

4.7 Sound recorder

4.8 FM radio

4.9 Melody composer

5 Phone Book

5.1 Quick Search

5.2 Add new contact

5.3 Copy all

5.4 Delete

5.5 Caller groups

5.6 Extra numbers

5.7 Phonebook Settings

5.8 Caller Picture

5.9 Caller ringtone

5.10 Caller video

6 Call center

6.1 Call history

6.1.1 Call history

6.2 Call settings

6.2.1 Call settings

6.2.2 Advance settings

6.2.2.1 Black list

6.2.2.2 Auto redial

6.2.2.3 Speed dial

6.2.2.4 Background sound

6.2.2.5 Call time display

6.2.2.6 Call time reminder

6.2.2.7 Auto quick end

7 Organizer

7.1 Bluetooth

7.2 Calendar

7.3 Tasks

7.4 Alarm

7.5 World clock

8 Messages

8.1 SMS

8.2 Write message

8.2.1 Inbox

8.2.2 Outbox

8.2.3 Templates

8.2.4 SMS settings

8.3 MMS

8.3.1 Write message

8.3.2 Inbox

8.3.3 Outbox

8.3.4 Drafts

8.3.5 Templates

8.3.6 MMS Settings

8.4 Chat

8.5 Voice mail server

8.6 Broadcast message

9 File manager

10 Services

10.1 WAP

10.2 Data account

10.2.1 GSM Data

10.2.2 GPRS data:

11 User Profiles

12 Settings

12.2 Phone setup

12.1.1 Time and Date

12.1.2 Schedule Power On/Off

12.1.3 Language

12.1.4 Preferred Input Method

12.1.5 Display setup

12.1.6 Greeting Text

12.1.7 Dedicated key

12.1.8 Auto update of date and time

12.1.9 UART setup

12.1.10 Misc.settings

12.2 Network Settings

12.2.1 Network selection

12.2.2 Preferred networks

12.3 Security setup

12.3.1 SIM security setup

12.3.2 SIM lock

12.3.3 Fixed dial

12.3.4 Barred dial

12.3.5 Change password

12.3.6 Phone lock

12.3.7 Auto Keyboard lock

12.3.8 Change password

12.3.9 Restore factory settings

13 Writing Language/Input Method

13.1 Overview

13.2 Key definitions

13.3 Instructions on input method

13.3.1 e.g. English Writing Language

13.3.1.1 Using the keypad

13.3.2 Number

13.4 Using the keypad

13.5 Symbol

Frequently Asked Questions

Maintenance guideline

Important Product Information Guide

1 Getting Started

1.1 Battery

The battery holds a small amount of charge and can be used immediately after unpacking. It performs best after three full charge/discharge cycles.

1.2 Removing and installing the battery

To remove the battery, follow the steps below:

- A. Loosen the screws by metal screwdriver attached to the Carabina, and remove the battery cover outwards from the top of the phone;
- B. Pull the battery out from the bottom of the phone.

Warning: Power off the device before taking the SIM card out; otherwise, your SIM card may be damaged.

To install the battery, follow the steps below:

- A. Insert the top of the battery into the top metal contacts;
- B. Slide the back cover onto the phone until it closes in place, tighten screws.

1.3 Charging the battery

In charge mode, the battery indicator flashes. If the device is switched off during charging, a charging indicator appears on the screen, indicating that the battery is being charged. If the battery is totally discharged, it may take a few minutes before the charging indicator shows.

When the battery is fully charged, the indicator displays full battery and stops scrolling. If your device is turned off, an image indicating that the battery is fully charged appears on the screen.

Normally, the charge process takes two and half hours. During the charge process, your battery, device, and the charger may become warm. This is normal.

When charging is finished, disconnect the AC socket from the charger and your phone.

Note:

Please place your phone in a ventilated place with the temperature ranging from -10°C to +55°C. Use the provided charger only. Using unauthorized chargers may cause danger and violate the warranty rules of the phone.

2 Connecting to the network

2.1 SIM card

Please insert a valid SIM (subscriber identity module) card into the phone before use.

Do not touch the metal surface of the card in case the information on the card may be lost or destroyed. Keep the card away from electricity and magnetism.

2.2 Installing and removing the SIM card

Power off your phone; remove the battery; disconnect charger.

Plug SIM card into the SIM slot.

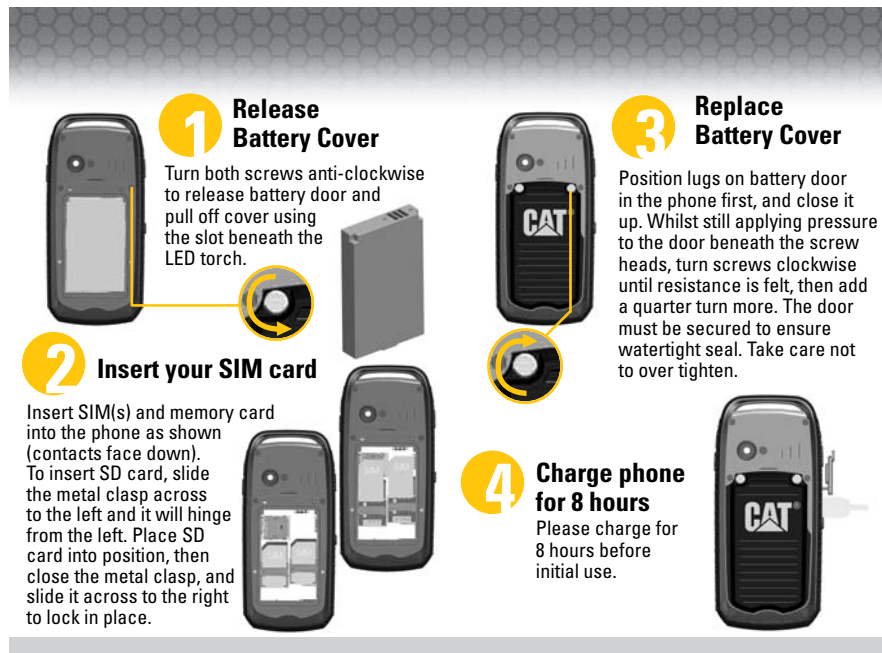

2.3 Installing and removing the memory card

Power off your phone; remove the battery; disconnect charger.

Insert the memory card into the micro USB card slot.

2.4 Switching on/off the device

Press and hold the End key to power on/off your device. The device will automatically test whether the SIM card is plugged in after power-on. If there is no SIM card, the device will prompt you to "Insert the SIM card". Then, the screen will display the following messages in turn:

Input password – if the password of the phone has been set.

Input PIN – if the password of the SIM card has been set.

Search – the phone starts searching until a proper network is found and connected.

2.5 Unlocking the SIM card

By setting a PIN (personal identification number) code of the SIM card, you can protect your SIM card from illegal use. If this function is activated and the PIN protection code is set, you have to input the PIN code to unlock the SIM card for regular use every time you power on your phone.

Users can clear the code. In this condition, the SIM card cannot be protected from illegal use.

- A. Hold the End key to switch on the phone;
- B. Input the PIN1 code, press "Clear" to erase the input errors and "Ok" to stop. For example, to set the PIN1 as "1234", input 1, 2, 3, and 4 in turn; then, press "Ok".

If you enter an incorrect PIN code three times in a row, the network will lock your SIM card and the phone will ask for PUK1 code.

Note:

Your network service provider will set a standard PIN code (4-8 digits) for your SIM card. Please change it with your private password.

2.6 Unlocking the device

By setting a password for your phone, you can protect your device from illegal use. After this function is selected, you have to input the password to unlock your phone for regular use. Users can deactivate the phone lock code. In this case, your device may not be protected from illegal use.

- A. Hold the End key to switch on the phone;
- B. Input the phone password. To clear any errors, press "Clear"; to end, press "Ok".

For example, if the password is set as "1122", enter 1, 1, 2, and 2 in turn and press "Ok".

If you forget your phone's password, please contact with the dealer or the authorized local customer service center.

2.7 Connecting to the network

After the SIM card is unlocked, the mobile phone will automatically search for the network and the screen displays a searching mark.

Once connected, the name of the network provider appears at the central top of the text and image area. Now you are registered on the network.

Note:

The prompt of "SOS" (Emergency call available) shown on the screen indicates that your phone is beyond the network service area or your card is not validated. However, you still can make an emergency call according the signal strength.

3 Basic Features

3.1 Coverage

Once the name of the network provider appears on the screen, you can make or answer a call. The signal bar on the upper left corner of the screen shows the strength of your phone's connection to the network. Four bars indicates the strongest signal.

3.2 Making DDD

3.2.1 Enter telephone number-by-number keys.

Press the Call key to make a call. To change a phone number, press the right soft key to clear the number. During dialing, a corresponding animation is displayed. Once the other party answers, the screen displays the call status. If the number is not in the Phone Book, your device only displays the other party's number. Otherwise, the Phone Book name would be displayed. If the number is saved by your phone, its type (Mobile phone/Home Number/Office Number, i.e.), email, caller picture, and caller group also display on the screen.

3.2.2 Dialing an extension number

For extension number, you have to dial the telephone exchange; then, press * Key to switch in a row until "P" shows on the screen. Now you can call an extension.

Allow you to follow the sequence below to call can extension:

Area code, telephone exchange, extension number, and Call key.

3.3 Making IDD

Press * Key and release it to enter the character "+" which replaces the international access code. This allows you to make a call to any country without knowing the local international access code.

Follow the sequence below to make an international call: "+", country code, whole telephone number, and Call key.

After inputting the access code, enter your required country code and the complete telephone number.

Omit "0" in front of a city code while dialing the number just as you dial the international call.

3.4 Dialing the number in the list

All calls you have made or received are saved in Call History. The recently dialed, received, and un-answered numbers are grouped as Calls Dialed, Calls Received, and Calls Un-answered. When the list is full, old numbers will be deleted automatically. To view the list follow the sequence below:

- A. Press the Call key in standby mode to view all call logs;
- B. Press Call key to dial any number in the list directly;
- C. When the list appears, press Ok to view details. Then, press Option to select an operation like saving the number or delete the number.

3.5 Making an emergency call

As long as the network service is available, which can be checked by the signal strength bar at the bottom left corner of the screen, you can make an emergency call. If your network provider does not provide roaming service in the area, the screen will only display (Emergency), indicating that you can make emergency calls only. If you are located in a service area of the network, emergency calls can also be made without a SIM card.

3.6 Answering a call

Press the "Call" key or "Answer" key to answer an incoming call. If an earphone is installed, you can use the key on the earphone to receive a call. For this, enable the auto answer mode and confirm that the earphone has been installed. Then, your phone will automatically answer an incoming call after the ring or vibration. If "Any Key" in the Answer Mode menu is selected, you can press any key in addition to the End key to receive a call.

3.7 Call history

Your device is able to save information like the recently Un-answered Calls, Received Calls, Dialed Calls, the Last CallTime, Total Sent time, Total Received time.

3.8 Call options

During a call, press "Option" to access the call options or "H-Free" to activate hands-free function. To turn off the loud speaker, press the same key. For call options, use the function menu.

This feature is only available during a call. Some functions like call waiting and call holding require the support of the network. Please contact your network supplier.

In Options, you can select

- **Hold single call**

To pause the current call.

- **End single call**

To end the current call.

- **New Call**

To let you to dial another telephone number.

- **Phone Book**

To access the phonebook menu.

- **Messages**

To access the SMS menu. Because the network service is in use during a call, the SMS function is not available at this time.

- **Sound recorder**

To make a sound recording.

- **Call Background sound**

To make a setting of background sound.

- **Mute**

You can switch on/off. The microphone will be switched off while the Mute option is selected.

- **DTMF**

You can switch on/off. DTMF is used to e.g. configure a hotline computer of your bank account or your mailbox. (While DTMF is set to on you can press the numbers on your phones keypad and a sound will be sent to the computer to configure the services.)

4 Multimedia

4.1 Camera

Press the Left Soft key to access the <Camera > function.

You can also press Option in the preview mode: to Photos, Camera Settings, Image Settings, White balance, Scene mode, Effect Settings, set frame, storage and Restore default.

4.2 Image viewer

By selecting image viewer menu, you can view the photo list that are saved in the album, and you can view, edit, browse style, use as, send, rename, delete ,delete all files , sort by, and storage.

You can select the photo to use as the wallpaper, screen saver, to power on display, to power off display, caller picture.

4.3 Video recorder

Your phone has Video Recorder function. To enter the Multimedia function, choose Video Recorder option.

In the Video Recorder interface, press the middle key to start, press it once again to pause press right key to stop, up and down key to adjust the focus; left or right key to select the EV.

Press option to enter the submenu.

CamCorder Settings: You can select options below:

White Balance: to choose Auto, Daylight, Tungsten, Fluorescent, Cloudy, Incandescent

EV: to have a choose of EV.

Night Mode: to turn Night Mode on/off.

Anti-flicker: to choose between 50Hz or 60Hz.

Effect Settings: change effects on images.

Storage: to choose phone or memory card.

Restore Default: to restore settings to default.

4.4 Video player

Select Video Player submenu to access movie list, you can access "Option" menu for the following operations:

Play: Shift from the player to Video player list to display the video files in the current list.

Use as: to caller video.

Send: as multimedia, via Bluetooth.

Rename: Change the name of the current video file.

Delete: Press it to delete the current video files.

Delete all files: Allow you to delete all video files.

Sort by: Press to sort the video files by name, by type, by time, by size, or none (At random).

Storage: to choose phone or memory card.

4.5 Photo editor

4.5.1 Photo artist

Allow you to select from file, capture from camera, resize image to choose the photo. And then choose auto resize, main LCD clip, manual clip to edit the photo. Press "Option" for the following operations:

Save as: to choose stored folder and edit filename to save the file.

Send: to send via multimedia message or bluetooth.

Add frame: to choose frame for the current photo.

Add icon: to choose icon for the current photo.

Add text: to edit the text and choose the text style for the current photo.

Mirror: to horizontally rotate the current photo.

Rotate: to rotate the current photo.

Add effect: to add effect for the current photo.

Redeye reduction: choosing an area to reduce redeye.

Expand canvas: to expand the current to whole canvas.

Undo: to cancel the last operation.

Exit: to exit photo artist.

Help: help!

4.5.2 Image tiles

Allow you to choose 2 image tiles, 4 image tiles, 9 image tiles to edit the image.

4.6 Audio player

In the audio player, use UP/DOWN key to play or stop playing music; Use the 2,8 key to adjust volume; , press "options" to access current play list of phone. In the Option menu, you can play the music file in the list, view the details, add music to the ring tone database, refresh the play list and set operations.

Specific settings in the setting options of a certain music file:

Pre.play list: to choose phone or memory card.

List auto gen.: When this function is set as ON, you can make the operation of "Update Play List" to update the music files in My Music directory in the [File Manager]\Memory Card into the play list without manual aid. When this function is set as OFF, you can select the music files in the added file folder in the Option into the play list, move the single music files in the play list and delete all music files in the play list.

Repeat: Allow you to set the repeat play mode of music, separately use Left/Right key to set it as OFF (No Repeated Play), repeat single music and repeat all.

Shuffle: set the play sequence, separately set as ON (Random Play) and OFF (play as per the current list sequence).

Background play: you can play the music when in other operations. (Except mute operation, camera operation and record operation.)

BT stereo output: to turn it on/off.

BT stereo headset: display the status of the headset.

Lyric display: on/off.

4.7 Sound recorder

Press left soft key to access recording options: you can record (new recording), play, Append, rename, delete, delete all files, settings, use as, send. You can select the recorded voice for user profiles and send as multimedia message and Bluetooth.

4.8 FM radio

Allow you to listen to FM broadcasts with your phone.

Channel list: Allows you to save 9 channels into the list.

Manual input: Allows you to input the desired frequency manually.

Preset Auto search: Select Preset Auto Search Setting List, then it will receive the frequency modulating broadcasting information according your location and save into the channel list.

Settings: Allows you to set the background play as ON or OFF, Loud speaker as ON or OFF, Record format and Audio quality, record storage.

Record: Allow you to have a record of the channel.

Append: Allow you to continue to record in saved file.

File list: Display all of the recording documents.

4.9 Melody composer

Press left soft key and confirm to add new ring tone, then the slave interface will appear, you can use the number keys to edit your desired music and then press left soft key "Option":

Play: you can play the music you just edited.

Play speed: you can set the play speed as fast, medium and slow .

Select instrument: Allows you to select your favorite music instrument to play, including guitar, violin, flute, Trumpet, etc. save: you can save the music you just edited.

5 Phone Book

This allows you to save information like names, phone numbers, and mobile phone numbers.

The phone numbers can be saved to your device or the SIM card. 1000 records can be stored in the device. For the SIM card, the quantity of the records depends on the capacity of the card.

5.1 Quick Search

Allow you to view records in the phone book. For the current number, you can Send SMS, Send MMS, View, Edit, Delete, Copy, Move, Send vCard etc.

5.2 Add new contact

Add a new entry in the directory To SIM or To Phone.

If saved To Phone, you can also save Name, Number, Home Number, Company Name, E-mail Address, Office Number, Fax Number, and Birthday.

Caller Picture: Set a caller picture for the current phone number. Allow you to choose a photo from the preset ones in the device or select a successfully previewed one with a correct size from File.

Caller video: Set a caller video for the current phone number. Allow you to choose a video from the preset ones in the device or select a successfully previewed one with a correct size from File.

Caller ringtone: Set a ring caller ID. Activate/deactivate the ring tone from the preset ones in the system or the folder of Files.

Caller Group: Group the phone number in phone book.

5.3 Copy all

Allow you to copy all records in the SIM card to your phone or vice versa.

Note:

Only the name and phone number of the contact are copied to the SIM card.

5.4 Delete

Allow you to delete all records or one by one in the SIM card or the phone.

5.5 Caller groups

Mobile phones support caller group function. In the caller group interface, select a group to view and edit the details. They include entries like the Group Name, Caller ringtone, Caller picture, Caller video, and group Members. Allows you to edit these entries, in which the picture can be selected from the File Management folder with size, and add or delete a group member.

Note:

Only the phone number recorded by your device can be increased or decreased.

5.6 Extra numbers

Allow you to Edit and Erase the Owner Number. Allow you to select the local number, service dialing number and SOS number.

5.7 Phonebook Settings

Memory Status: Allow you to view the storage capacity of the phone and the SIM card, as well as the space occupied.

Preferred Storage: Allow you to default a position (SIM or Phone) to save the phone numbers or select one while saving a number.

Fields: Allow you to select the home number, company name, Email address, office number, fax number, birthday, caller picture, caller video, caller ringtone and caller group, etc.

My vCard: Allow you to edit My vCard and Send my vCard.

vCard Version: Allow you to choose vCard 2.1 or vCard 3.0.

5.8 Caller Picture

Set a caller picture for the current phone number. Allow you to choose a photo from the preset ones in the device or select a successfully previewed one with a proper size from File.

5.9 Caller ringtone

Set a ring caller ID. Activate/deactivate the ring tone from the preset ones in the system or the folder of Files.

Note:

The files in Files can only be selected after being sent to profile.

5.10 Caller video

Set a caller video for the current phone number. Allow you to choose a video from the preset ones in the device or select a successfully previewed one with a proper size from File.

6 Call center

6.1 Call history

6.1.1 Call history

To view information about call records, select Call History in the main menu. The information includes the Missed Calls, Dialed Calls, Received Calls, Delete Call Log, Call Timers, Call Cost, SMS Counter, and GPRS Counter etc.

Missed calls: check the list of missed calls.

Dialed calls: check the list of dialed calls.

Received calls: check the list of received calls.

Delete call logs: to delete all the entries.

Choose one entry, you can check the details, including date, time, number, call times, and the call duration.

There are the following operations to the detailed information:

Delete: delete the entry

Save to phonebook: save the number to SIM or phone book.

Call: dial the number.

Edit: edit the number and save it to phonebook or send SMS, send MMS.

Send text message: send a new short message to this number.

Send multimedia message: send a new multimedia message to this number.

Call timers: There are four submenus of the call duration.

Last call: the duration of last call.

Dialed calls: call duration for all the dialed calls.

Received calls: call duration for all the received calls.

Reset all: clear all the data and begin to recount.

SMS counter: There are two submenus of the call cost.

Reset counter: clear all data and restart counting.

6.2 Call settings

6.2.1 Call settings

Caller ID: You can change the default of the system - hide number or send number provided if supported by the network operator.

Call waiting: You will be notified of a new incoming call during the current one if this function is activated. For more information, contact your network provider.

Call divert: This service enables you to forward an incoming call of a certain business to the telephone number you specified. This service requires the support of the network. Contact your network supplier to open this service.

Allow you to select any one from Divert All Voice Calls (A forwarding icon displays at the status bar in standby mode after it is activated), Divert If Unreachable, Divert If No Answer, Divert If busy, and Divert All Data Calls. Then, the following options appear.

Activate: Allow you to set the Divert Number.

Deactivate: Allow you to cancel call-forwarding service.

Query Status: Allow you to check the status of the service.

To bar the functions above while not in need, select Cancel All Divert.

Call barring: Access the submenu, and you can set the following items to improve the security. Some network providers may not offer this service. For more information, contact your network supplier. Your network provider will provide you with a four-digit password to activate this service. Enter the menu, and then you have the following items.

Outgoing Calls: Allow you to activate, deactivate, or check this restriction towards all calls, International Calls or International Calls except to Home Country.

Incoming calls: In this menu, you can activate, deactivate, and check the restriction of all incoming calls, i.e. bar All Calls; or activate, deactivate, and check all incoming calls when Roaming.

Activate all: Allow you to activate all call barring services by inputting your password.

Cancel All: Allow you to cancel all call barring services by inputting your password.

Change Barring PW: Enter the old call barring password and then the new one.

Line Switching: You can select to switch over Line 1 and Line 2.

6.2.2 Advance settings

6.2.2.1 Black list

Enables the rejection of calls from numbers stored in the black list, the call is recorded in the rejected history list.

Reject from list

To turn on /off

Black list number

To setup the black list

6.2.2.2 Auto redial

Set it as On or Off to activate or deactivate this function.

6.2.2.3 Speed dial

Allows you to set up speed dial list and 8 speed dial numbers. Set to on, you can access from standby, hold down the number from 2 to 9, to dial the stored numbers.

6.2.2.4 Background sound

Allow you to have a setting of background sound, during a call.

6.2.2.5 Call time display

Allow you to activate or deactivate this function.

6.2.2.6 Call time reminder

This prompts you of the call duration of a certain period. Enter this menu, and you will have the following options.

Off: Deactivate the function.

Single: Input any numbers between 1 and 3000 (Unit: seconds) to set a period for the hint.

Periodic: Input any digits between 30 and 60 (Unit: seconds) to set a cycle for the hint.

6.2.2.7 Auto quick end

Set to On or Off , and the period of 1 to 9999 seconds.

7 Organizer

Allow you to use Calendar, Tasks, and Alarm clock, World clock, Note.

7.1 Bluetooth

7.2 Calendar

In the submenu, the screen displays the calendar for the current month and the actual date is highlighted.

To view the date, press the Up/Down/Left/Right key. The calendar information refreshes upon your selection.

7.3 Tasks

Schedule a tasks list using this application. You will be reminded of your tasks according to the mode you have set.

7.4 Alarm

Five alert types and power-off alarm are supported. In the alarm clock list, select one to set the following entries, On/Off, 00:00 (Time), Repeat, Snooze, and the Alert Type. The Repeat entry can be set as Once, Everyday, and Days (working days, defaulted as Monday to Friday, however, the option can be customised). FM radio can be set as the alarm clock.

7.5 World clock

You can view the time around the world.

To turn on /off.

And in any interface long press ok key or press the lamp key on the left side of your handset to turn on/off it.

8 Messages

8.1 SMS

8.2 Write message

Access the SMS editing interface to write the text. To select an option, press Option.

Done: Upon finishing editing, you can select Option for the following operations: Send only, Save and send, Save, Send to many, and Send by group.

Use templates: In the default cursor, add the commonly used phrase.

Insert object: to insert a picture, animation or something to the message.

Text Format: to define the text format. (text size/ text style, alignment, and new paragraph)

Insert number: Allow you to select number from the phone book.

Insert name: Allow you to select name from the phone book.

Insert bookmark: Allow you to add bookmarks.

Input method: Various input methods for options.

8.2.1 Inbox

Select it to view the received messages. While viewing the message list, use the Up/Down key to select the previous or next message. To read a message, press "Ok". In this interface, press Option and you will find the following entries: Reply, Delete, Forward, Copy to Phone/SIM, Move to Phone/SIM, Delete All, Copy all, Move all, Use Number, Use URL, chat.

8.2.2 Outbox

Select it to view the messages you save in the device or the SIM card.

While viewing the message list, press "Ok" to read details.

While reading a message, you can press "Option" to select your required operation as Send from SIM1/ SIM2, edit, Delete , Copy to Phone/SIM, Move to Phone/SIM, Delete All, Copy all, Move all, Use Number, Use URL.

8.2.3 Templates

There are several short sentences as default SMS that could be deleted or edited.

8.2.4 SMS settings

SMS should work out of the box. In the unlikely event it does not, then some settings may have to be manually input. Access the submenu to set the following items.

Profile Settings: Please contact your local network supplier to get the number of SMS service center. Access the submenu, and the mode list appears. The mode number varies with the different network supplier and the SIM card. Select a mode. Then, press Edit to set the Profile Name, SC address, Validity Period, and MessageType in turn.

Note:

The network operator should support Functions like the expiry date of the message, the fax, message call, and the e-mail.¹

Common Settings: Allows you to activate or deactivate the Delivery Report and Reply Path.

Memory Status: Displays the occupied memory of your SIM card or device in n/m.

Preferred Storage: Change default location (SIM card or the device) to save your MMS.

8.3 MMS

MMS refers to the multimedia messaging service. It is a multimedia feature, enabling you to send information of various multimedia formats like text, images, and sounds.

The network operator should support this service. Make sure whether your SIM card supports it or contact a corresponding operator before use.

If your phone supports this feature, you can send and receive multimedia messages after necessary settings.

Access the submenu of MMS, and you will find Write Message, Inbox, Outbox, Drafts, Templates, and MMS Settings.

8.3.1 Write message

Access the MMS editing interface. To add the addressee's number or Email. In addition, you can edit the subject and content. Select "Edit content" to enter into editing interface. You can do the following operation:

Add number: Allows you to add recipient's numbers.

Add Email: Allows you to add recipient's email.

Edit: Allows you to edit selected number of recipients.

Delete: Allows you move the current number of recipients out of the recipient list.

Access the MMS editing interface to write the text. Press "Option" to access the following interface:

Done: Upon finishing editing, you can select Option for the following operations: Send only, Save and Send, Save to Drafts, Save as template, Send options, and Exit.

Input method: Various input methods for options.

Add picture: Allow you to add pictures.

Add audio: Allow you to add voice files.

Add video: Allow you to add images.

Add attachment: Allow you to add attachment.

Add slide before: Allow you to add a new page in the front of the previous one.

Add slide after: Allow you to add a new page in the back of the previous one.

Add bookmark text: Allow you to add the bookmarks saved in WAP.

Preview: Allow you to preview multimedia message.

Slide timing: Allow you to set up the slide time when you preview multimedia message.

Upon finishing editing, you can select Option for the following operations: Send only, Save and Send, Save to Drafts, Save as template, Send Options and Exit.

8.3.2 Inbox

All received messages are stored in the Inbox. Allow you to perform the operations towards the current MMS, such as delete, view and so on.

8.3.3 Outbox

The Outbox saves all messages that are sent while selecting the entry Save.

8.3.4 Drafts

For messages not ready to send, they are stored in the Drafts folder, waiting to be modified and sent.

8.3.5 Templates

Five multimedia messages are preset in the phone. Allows you to view and edit the message, as well as access them directly.

8.3.6 MMS Settings

Compose: Allow you to set the creation mode, picture resizing, best page time, auto signature, signature.

Send: Allow you to set the validity period, delivery report, read report, priority, slide timing, delivery time.

Retrieve: Allow you to set the home network, roaming, and read report and delivery report.

Filter: Allow you to set the options of Anonymous and other information you want to filter.

Server profile: to choose SIM1 or SIM2 (if dual SIM device).

Memory Status: Allows you to view the memory occupation.

8.4 Chat

Allows you to set two rooms and establish "My nickname" and "Destn. Number". Then, you can start chatting with the other party using messages.

8.5 Voice mail server

If you cannot answer a call, you can ask the other party leave a message to you via this service. Then, access the Voice Mail Server to listen to the message. The network operator should support this service. Therefore, you may need to activate before use.

8.6 Broadcast message

The broadcast messages refer to the public messages sent by the operator. This service enables you to receive information relating to subjects like weather, taxi, and hospitals from the operator. For the available subject information, consult your network supplier.

9 File Manager

Access the submenu, and you will find the entry of phone operating system, Phone, and Memory card (if available). On the top of the interface displays the total memory space and the remained space of the selected disc. Press "Option" to have the following operations:

Open: Press to list the contents and file under the menu.

New folder: Edit a name to create a folder.

Rename: Change the name of the current folder.

Delete: Press it to delete the current folder.

Sort by: Press to sort the folder and files by name, by type, by time, by size, or none (At random). Select a file. Then, press Option to display the following options.

10 Services

Press the Left soft key to access the function menu interface. Please choose the network service and press the left soft key to access the service menu interface.

If your SIM card and the service provider support the service, you can access through mobile phone. If you want to get more information, please contact with the supplier.

10.1 WAP

Homepage: select this menu; you can enter the default website to get the information about entertainment, movies, fashion, friends, games, etc.

Bookmarks: to enter the default WAP website.

Recent pages: to check the recently-entered websites in this menu.

Offline pages: to check the websites saved in this menu.

Input address: input the address of the website you want to surf.

Service inbox: to store the push messages.

Settings: select SIM, edit account, browser options, service message settings, clear cache, clear cookies, etc.

10.2 Data account

10.2.1 GSM Data

Account name: the name of the account, choose edit to amend.

Number: the number of the account.

User name: the name of dial-in service not WAP gateway .

Password: the password of dial-in service not WAP gateway .

Line type: to choose line type, analogue or ISDN.

Speed: to choose the speed.

Primary DNS: Primary IP address.

Secondary DNS: Secondary IP address.

10.2.2 GPRS data:

Account name: the name of the account, choose edit to amend.

APN: input APN.

User name: the name of dial-in service (not WAP gateway).

Password: the password of dial-in service (not WAP gateway).

Auth.Type: to choose the type of the authentication.

Primary DNS: Primary IP address.

Secondary DNS: Secondary IP address.

11 User Profiles

Several customised scene modes are provided to users, to choose the different mode for the different environment, such as General, meeting, outdoor, indoor, headset, Bluetooth type, and tone setup, volume, alert type, ring type, extra tone, answer mode. Can be customised accordingly.

12 Settings

Select “Settings” in the Main Menu. Then, you can perform Phone Setup, Network Setup, Security Setup, and Restore Factory Settings etc.

12.1 Phone setup

12.1.1 Time and Date

Allow you to Set home city, Time/Date, Set Format.

12.1.2 Schedule Power On/Off

Four entries are provided for you to edit. The phone can be switched on or off as you preset.

Note:

If the time options are set same, they may not be activated at the same time. This may cause a conflict.

12.1.3 Language

Allow you to set the display language, about 15 languages.

12.1.4 Preferred Input Method

Various input methods are provided for you to choose.

12.1.5 Display setup

You can set Wallpaper, Screen Saver, Power on Display, Power off Display, Show Date and Time, and Show Owner Number, and clock type.

12.1.6 Greeting Text

Allows you to edit the greeting displayed on the device when it is switched on.

12.1.7 Dedicated key

Customise the navigation key with shortcuts to you most used functions.

12.1.8 Auto update of date and time

Allow you to set this function as ON or OFF.

12.1.9 UART setup

Allow you to choose SIM Card

12.1.10 Misc. settings

LCD Backlight

Allow you to set the time of the LCD back light and Brightness.

12.2 Network Settings

12.2.1 Network selection

For the Selection Mode, you can switch between Manual and Automatic.

User could choose SIM 1 network or SIM 2 network for setting. (Only if dual SIM device)

12.2.2 Preferred networks

Select the favorite network operator, the one displayed in default status is the local network current used in SIM card. Click options to access the following operations:

Add from list: To display all PLMN list, approx 223.

New: To add networks and priority of use.

Change priority: To set the priority of network.

Delete: Delete the favorite network used currently.

Note:

The network operator may decide whether to provide this service.

12.3 Security setup

The settings of the security options of your phone will protect your device or SIM card from unauthorised use.

12.3.1 SIM security setup

12.3.2 SIM lock

To turn SIM lock on or off.

12.3.3 Fixed dial

If supported by your SIM card, you can define select telephone numbers to dial. If this service is activated, you can only dial the telephone number in the FDN list or the number started with some numbers in front of the telephone number in the list.

Access the "Fixed dial" submenu, and you can set the following items.

Mode: Enter the PIN2 code to switch on or off this service.

Fixed Dial List: Press Ok to enter the menu of the FDN list. Press Option to Edit or Delete the number. If the list is empty, press Add to add phone numbers into the list.

Note:

The PIN2 code is required to switch on or off this service. Please contact your network supplier for the code. After it is activated, the Phone Book displays the number in the list.

12.3.4 Barred dial

If supported by your SIM card, you can bar defined telephone numbers to dial. If this service is activated, the phone will be barred to dial the number you have set.

Note:

The PIN2 code is required to switch on or off this service. Please contact your network supplier for the code. In addition, the phone number you have set will not display in the Phone Book.

12.3.5 Change password

Password length for SIM must be between 4 and 8 numbers to successfully confirm the password change successfully.

12.3.6 Phone lock

Your phone can be protected against unauthorized use if stolen by using this function.

Access the submenu, and you can set the following items:

Allow you to select On and enter the Phone lock code. Next time you power on the device, a correct password is required. If the Phone lock has been activated, you can choose Off to deactivate the protection.

Note:

The Phone lock code as default is 1122.

12.3.7 Auto Keyboard lock

Allow you to choose close, 5 seconds, 30 seconds, 1 minute or 5 minutes.

In the standby screen manually lock the keyboard is defined as:

Hung up key & # key

Manually unlock is defined as:

Right soft key & # key

12.3.8 Change password

Allow you to change the phone password.

12.3.9 Restore factory settings

In this menu, enter the phone password and press Ok. Then, the settings of corresponding parameters will be restored as default.

13 Writing Language/Input Method

13.1 Overview

Your device supports the following input methods: English (ABC and abc), numbers, and symbols, etc.

13.2 Key definitions

Ok key: In the interface of Input Method, press Ok to select your required method. While editing a message, press it to access the

“Option” submenu, and finish editing or enter the EMS menu for edit.

Navigation key (Up/Down/Left/Right key): Press to move the cursor or for selection.

13.3 Instructions on input method

13.3.1 e.g. English Writing Language

For this input method, the keypad is defined as below.

For the keypad definition in English input mode, including Capital English input and Normal English input, refer to the table below. In the column of "Corresponding character or function", the mark ";" works as the division for Smart English ABC and Smart English abc.

When there is no semi-colon, it indicates that the two corresponds to the same characters:

Key name	Corresponding character or function
Number key "0"	0, space
Number key "1"	Symbols
Number key "2"	ABC2; abc2
Number key "3"	DEF3; def3
Number key "4"	GHI4; ghi4
Number key "5"	JKL5; jkl5
Number key "6"	MNO6; mno6
Number key "7"	PQRS7; pqrs7
Number key "8"	TUV8; tuv8
Number key "9"	WXYZ9; wxyz9
* key	Call the symbol input box
# key	Change the input method
Up key	Move the cursor upward
Down key	Move the cursor downward
Left key	Move the cursor leftward
Right key	Move the cursor rightward
Right soft key	Back or Clear
End key	Return to the standby mode

13.3.1.1 Using the keypad

For general operations, refer to the part below.

Each key allows you to input more than one character. Press a key repeatedly and fast until your required character shows.

To enter an English punctuation or special symbol, press * key to show the special symbols input box in the English input mode, including capital mode and normal mode.

To change an input method, press # key.

To input a space in English input mode, press Number key "0" once.

To clear one input error, press the Right Soft key. To clear all, press and hold the same key.

13.3.2 Number

Refer to the table below for key definitions in this mode.

For this input method, the keypad is defined as below.

Key name	Corresponding character or function
Number key "1"	1
Number key "2"	2
Number key "3"	3
Number key "4"	4
Number key "5"	5
Number key "6"	6
Number key "7"	7
Number key "8"	8
Number key "9"	9
Number key "0"	0
# key	Change the input method
Up key	Move the cursor upward
Down key	Move the cursor downward
Left key	Move the cursor leftward
Right key	Move the cursor rightward
Left soft key	Ok
Right soft key	Back or Clear
End key	Return to the standby mode

13.4 Using the keypad

For general operations, refer to the part below.

- Press the Number key (0-9) to enter the corresponding number.
- To change an input method, press # key.
- To delete wrong inputs, press the Right Soft key to select Clear. Press and hold it to delete all.

13.5 Symbol

Using the keypad: To access the symbol box during editing mode, press * key. To select your required symbol, press the navigation keys. Then, press Ok to confirm.

Frequently Asked Questions

Prior to contacting the after-sales service providers, please make the following simple inspection to save the maintenance time and expenses for you as much as possible.

Common Troubles

Causes and Resolutions

Cannot power on

Check if the pressing on the Startup Key for at least more than 1 second;

Check if the battery contact, please take out the battery and then re-insert and try to restart;

Check if the battery has charge, if not, please charge

Cannot connect to network

Signal strength is too weak, try another location with better coverage;

The cell phone is out of the network coverage of network service provider;

SIM card is invalid, please contact your network supplier;

It display message upon startup

Check if SIM card is installed correctly;

If auto lock function is enabled, please input the phone password before use;

If SIM lock function is enabled for every startup, you must input PIN code;

Input PUK code: The phone will be locked if you incorrectly enter PIN code three times, you have to enter PUK code provided by your network operator;

Poor quality of calls

Please check if the volume is adjusted properly;

When this phone is used in the areas with poor signal, e.g. near the high buildings or in basements, the call quality will be affected;

When this cell phone is used in calling intensity period, like the rush hours, calling failure is caused by network congestion;

Standby time is reduced	<p>Standby time is related to the system setting of network, maybe the phone is used in an area with poor signal. Where there is poor signal, the phone will constantly search for base station signal and battery will run down, so the standby time is reduced.</p> <p>Try replacing battery if occurring in good signal area.</p>
SIM card error	<p>Check SIM card contacts - please use a clean cloth to wipe the metal contact point of SIM card;</p> <p>Check SIM card is properly installed;</p> <p>SIM card is damaged, please contact with your network service provider.</p>
Calls cannot be dialed	<p>Make sure the Send key is pressed after dialing number</p> <p>Make sure call credit is sufficient;</p> <p>Please make sure if SIM card is valid;</p> <p>Please make sure call barring function is enabled;</p> <p>Make sure fixed dialing function is not restricting calls;</p>
The caller cannot contact you	<p>Please check the phone is powered on and connected to a network;</p> <p>Make sure call credit is sufficient;</p> <p>Please make sure if SIM card is valid;</p> <p>Please make sure call barring function is enabled;</p> <p>Make sure fixed dialing function is not restricting calls;</p>
Battery will not charge	<p>Poor contact, please check the plug connection;</p> <p>Ensure environmental conditions within temperature range -10 to 55°C</p> <p>Battery or charger may be damaged, please replace it;</p>
Some functions cannot be set	<p>Wrong operation;</p> <p>The network provider does not support this function or you have not activated this function.</p>

Maintenance Guideline

If there is a problem using the mobile phone, please contact your vendor.

Important Product Information Guide

This *Important Product Information Guide* contains safety and handling for Cat B25.

Look for recycling, disposal, and other environmental information at:
<http://www.catphones.com/>

To avoid injury, read all operating instructions and the following safety information before using Cat B25.

Important Safety and Handling Information

WARNING: Failure to follow these safety instructions could result in fire, electric shock, or other injury or damage to Cat B25 or other property.

General Usage: Cat B25 has been designed to be significantly more rugged than a normal mobile phone, however it is NOT indestructible.

Carrying and Handling Cat B25: Cat B25 contains sensitive components. Do not drop, disassemble, open, crush, bend, deform, puncture, shred, microwave, incinerate, paint, or insert foreign objects into Cat B25. Do not use Cat B25 if it has been damaged—for example, if Cat B25 is cracked, punctured, or damaged by water. The screens of Cat B25 are made of glass. This glass could break if Cat B25 is dropped on a hard surface or receives a substantial impact or is crushed, bent, or deformed. If the glass chips or cracks, do not touch or attempt to remove the broken glass. Stop using Cat B25 until the glass is replaced by a Cat B25 Authorized Service Provider. Glass cracked due to misuse or abuse is not covered under the warranty.

Keeping the Outside of Cat B25 Clean: Clean Cat B25 immediately if it comes into contact with any contaminants that may cause stains, such as ink, dyes, makeup, dirt, food, oils, and lotions. To clean Cat B25, unplug all cables and turn off Cat B25. Then use a soft, slightly damp, lint-free cloth. Avoid getting moisture in openings. Don't use window cleaners, household cleaners, aerosol sprays, solvents, alcohol, ammonia, or abrasives to clean Cat B25. The front screen surfaces have an oleophobic coating. To remove fingerprints, simply wipe these surfaces with a soft, lint-free cloth. The ability of this coating to repel oil will diminish over time with normal usage, and rubbing the screen with an abrasive material will further diminish its effect and may scratch the glass.

Dust and Water: The Cat B25 is fully tested to meet IP67 specifications. It is very important to note that all of the Cat B25 connectors, covers and battery compartment are correctly fitted and have the correct O-rings fitted to meet the waterproof and dust specifications. Failure to ensure all connector, covers, battery compartment and O rings are correctly fitted will invalidate the warranty. In case the Cat B25 gets wet, turn off Cat B25 before cleaning, and allow it to dry thoroughly before turning it on again. Do not attempt to dry Cat B25 with an external heat source, such as a microwave oven or hair dryer.

Repairing or Modifying Cat B25: Never attempt to repair or modify Cat B25 yourself. Cat B25 does not contain any user-serviceable parts, except for the SIM card, SD card (if fitted), Battery and Battery Compartment door. Disassembling Cat B25, including the removal of external screws and back cover, may cause damage that is not covered under the warranty. Service should only be provided by a Cat Authorized Service Provider. If you have questions, contact a Cat B25 Authorized Service Provider.

Charging Cat B25: To charge Cat B25, only use the Cat B25 Connector to USB Cable or a high-power USB port on another device that is compliant with the USB 2.0 or 1.1 standard, or another Cat branded product or accessory designed to work with Cat B25, or a third-party accessory certified to use with Cat phones.

Read all safety instructions for any products and accessories before using with Cat B25. Cat is not responsible for the operation of, or any damage caused by, third-party accessories or their compliance with safety and regulatory standards.

When you use the Cat B25 USB Power Adapter to charge Cat B25, make sure that the power adapter is fully assembled before you plug it into a power outlet. Then insert the Cat B25 USB Power Adapter firmly into the power outlet. Do not connect or disconnect the Cat B25 USB Power Adapter with wet hands.

The Cat B25 USB Power Adapter may become warm during normal use. Always allow adequate ventilation around the Cat B25 USB Power Adapter and use care when handling. Unplug the Cat B25 USB Power Adapter if any of the following conditions exist:

- The power cord or plug has become frayed or damaged.
- The adapter is exposed to rain, liquid, or excessive moisture.
- The adapter case has become damaged.
- You suspect the adapter needs service or repair.
- You want to clean the adapter.

Avoiding Hearing Damage: Permanent hearing loss may occur if the receiver, earbuds, headphones, speakerphone, or earpieces are used at high volume. Set the volume to a safe level. You can adapt over time to a higher volume of sound that may sound normal but can be damaging to your hearing. If you experience ringing in your ears or muffled speech, stop listening and have your hearing checked. The louder the volume, the less time is required before your hearing could be affected. Hearing experts suggest that to protect your hearing:

- Limit the amount of time you use the receiver, earbuds, headphones, speakerphone, or earpieces at high volume.
- Avoid turning up the volume to block out noisy surroundings.
- Turn the volume down if you can't hear people speaking near you.

For information about how to adjust volume on the Cat B25, see information elsewhere in this guide.

Emergency Calls: You should not rely on wireless devices for essential communications, such as medical emergencies. Use of Cat B25 to call emergency services may not work in all locations or all operating conditions. Emergency numbers and services vary by region, and sometimes an emergency call cannot be placed due to network availability or environmental interference. Some cellular networks may not accept an emergency call from Cat B25 if it does not have a SIM, if the SIM is PIN-locked, or if you have not activated your Cat B25.

Driving and Riding Safely: Use of Cat B25 alone or with headphones (even if used only in one ear) while driving a vehicle or riding a bicycle is not recommended and is illegal in some areas. Check and obey the laws and regulations on the use of mobile devices like Cat B25 in the areas where you drive or ride. Be careful and attentive while driving or riding a bicycle. If you decide to use Cat B25 while driving, keep in mind the following guidelines:

- **Give full attention to driving or riding and to the road.** Using a mobile device while driving or riding may be distracting. If you find it disruptive or distracting while operating any type of vehicle, riding a bicycle, or performing any activity that requires your full attention, pull off the road and park before making or answering a call.
- **Get to know Cat B25 and its features such as Voice Control, Favourites, Recent, and Speaker.** These features help you to place your call without taking your attention off the road. See the Cat B25 User Guide for more information.
- **Use a hands-free device.** Take advantage of one of the many compatible hands-free accessories available for use with Cat B25. Use of a hands-free device may be required in some areas.

- **Position Cat B25 within easy reach.** Keep your eyes on the road. If you get an incoming call at an inconvenient time, let your voicemail answer it for you.
- **Try to plan calls when your car will be stationary.** Assess the traffic before dialing, or place calls when you are not moving or before pulling into traffic.
- **Let the person you are speaking with know you are driving.** If necessary, suspend the call in heavy traffic or hazardous weather conditions. Driving in rain, sleet, snow, ice, fog, and even heavy traffic can be hazardous.
- **Do not text, email, take notes, look up phone numbers, or perform any other activities that require your attention while driving.** Composing or reading texts and emails, jotting down a to-do list, or flipping through your address book takes attention away from your primary responsibility, driving safely.
- **Do not engage in stressful or emotional conversations that may be distracting.** Make people you are talking with aware you are driving and suspend conversations that have the potential to divert your attention from the road.

Navigating Safely: Do not rely on Cat B25 applications that provide maps, digital compass headings, orientation information, directions, or location-based navigation to determine precise locations, proximity, orientation, distance, or direction. These applications should only be used for basic navigation assistance. Maps, directions, and location-based applications depend on data services. These data services are subject to change and may not be available in all geographic areas, resulting in maps, digital compass headings, directions or location-based information that may be unavailable, inaccurate, or incomplete.

Do not use location-based applications while performing activities that require your full attention. For important information about driving safety, see the “Driving and Riding Safely” section. Always comply with posted signs and the laws and regulations in the areas where you are using Cat B25.

For Vehicles Equipped with an Air Bag: An air bag inflates with great force. Do not store Cat B25 or any of its accessories in the area over the air bag or in the air bag deployment area.

Seizures, Blackouts, and Eyestrain: A small percentage of people may be susceptible to blackouts or seizures (even if they have never had one before) when exposed to flashing lights or light patterns such as when playing games or watching video. If you have experienced seizures or blackouts or have a family history of such occurrences, you should consult a physician before playing games (if available) or watching videos on your Cat B25. Discontinue use of Cat B25 and consult a physician if you experience headaches, blackouts, seizures, convulsion, eye or muscle twitching, loss of awareness, involuntary movement, or disorientation. To reduce risk of headaches, blackouts, seizures, and eyestrain, avoid prolonged use, hold Cat B25 some distance from your eyes, use Cat B25 in a well-lit room, and take frequent breaks.

Choking Hazards: Cat B25 contains small parts, which may present a choking hazard to small children. Keep Cat B25 and its accessories away from small children.

Repetitive Motion: When you perform repetitive activities such as typing or playing games on Cat B25, you may experience occasional discomfort in your hands, arms, shoulders, neck, or other parts of your body. Take frequent breaks and if you have discomfort during or after such use, stop use and see a physician.

Potentially Explosive Atmospheres: Turn off Cat B25 when in any area with a potentially explosive atmosphere. Do not charge Cat B25, and obey all signs and instructions. Sparks in such areas could cause an explosion or fire, resulting in serious injury or even death.

Areas with a potentially explosive atmosphere are often, but not always, marked clearly. Potential areas may include: fueling areas (such as gas stations); below deck on boats; fuel or chemical transfer or storage facilities; vehicles using liquefied petroleum gas (such as propane or butane); areas where the air contains chemicals or particles (such as grain, dust, or metal powders); and any other area where you would normally be advised to turn off your vehicle engine.

Using Connectors and Ports: Never force a connector into a port. Check for obstructions on the port. If the connector and port don't join with reasonable ease, they probably don't match. Make sure that the connector matches the port and that you have positioned the connector correctly in relation to the port.

Accessories and Wireless Performance: Turning on Airplane Mode on Cat B25 may eliminate audio interference between Cat B25 and an accessory. While Airplane mode is on, you cannot make or receive calls or use features that require wireless communication. Under some conditions, certain accessories may affect Cat B25 wireless performance. Reorienting or relocating Cat B25 and the connected accessory may improve wireless performance.

Keeping Cat B25 Within Acceptable Temperatures: Cat B25 is designed to be operated in temperatures between 0° and 35° C (32° to 95° F) and stored in temperatures between -20° and 45° C (-4° to 113° F). Low- or high-temperature conditions might temporarily shorten battery life or cause Cat B25 to temporarily stop working properly. Leaving Cat B25 in a parked vehicle or in direct sunlight can cause Cat B25 to exceed these storage or operating temperature ranges. Avoid dramatic changes in temperature or humidity when using Cat B25 as condensation may form on or within Cat B25.

When you're using Cat B25 or charging the battery, it is normal for Cat B25 to get warm. The exterior of Cat B25 functions as a cooling surface that transfers heat from inside the unit to the cooler air outside.

Exposure to Radio Frequency: Energy Cat B25 contains radio transmitters and receivers. When on, Cat B25 receives and sends out radio frequency (RF) energy through its antennas. The Cat B25 cellular antenna is located at the bottom edge of Cat B25, to the left of the Home button. The Wi-Fi and Bluetooth® antenna is located at the top edge of Cat B25, to the right of the headset jack.

For optimal mobile device performance and to be sure that human exposure to RF energy does not exceed the FCC, IC, and European Union guidelines, always follow these instructions and precautions: When on a call using the built-in audio receiver in Cat B25, hold Cat B25 with the dock connector pointed down toward your shoulder to increase separation from the antenna. When using Cat B25 near your body for voice calls or for wireless data transmission over a cellular network, keep Cat B25 at least 15 mm (5/8 inch) away from the body, and only use carrying cases, belt clips, or holders that do not have metal parts and that maintain at least 15 mm (5/8 inch) separation between Cat B25 and the body.

Cat B25 is designed and manufactured to comply with the limits for exposure to RF energy set by the Federal Communications Commission (FCC) of the United States, Industry Canada (IC) of Canada, and regulating entities of Japan, the European Union, and other countries. The exposure standard employs a unit of measurement known as the specific absorption rate, or SAR. The SAR limit applicable to Cat B25 set by the FCC is 1.6 watts per kilogram (W/kg), 1.6 W/kg by Industry Canada, and 2.0 W/kg by the Council of the European Union. Tests for SAR are conducted using standard operating positions (i.e., at the ear and worn on the body) specified by these agencies, with Cat B25 transmitting at its highest certified power level in all tested frequency bands. Although SAR is determined at the highest certified power level in each frequency band, the actual SAR level of Cat B25 while in operation can be well below the maximum value because Cat B25 adjusts its cellular transmitting power based in part on proximity to the wireless network. In general, the closer you are to a cellular base station, the lower the cellular transmitting power level.

Cat B25 has been tested and meets the FCC, IC, and European Union RF exposure guidelines for cellular, Wi-Fi, and Bluetooth operation.

Cat B25's SAR measurement may exceed the FCC exposure guidelines for body-worn operation if positioned less than 15 mm (5/8 inch) from the body (e.g., when carrying Cat B25 in your pocket).

If you are still concerned about exposure to RF energy, you can further limit your exposure by limiting the amount of time using Cat B25, since time is a factor in how much exposure a person receives, and by using a hands-free device and placing more distance between your body and Cat B25, since exposure level drops off dramatically with distance.

Additional Information: For more information from the FCC about exposure to RF energy, see: www.fcc.gov/oet/rfsafety The FCC and the U.S. Food and Drug Administration (FDA) also maintain a consumer website at www.fda.gov/Radiation-EmittingProducts/RadiationEmittingProductsandProcedures/HomeBusinessandEntertainment/CellPhones/default.htm to address inquiries about the safety of mobile phones. Please check the website periodically for updates.

For information about the scientific research related to RF energy exposure, see the EMF Research Database maintained by the World Health Organization at: www.who.int/peh-emf/research/database

Radio Frequency Interference: Radio-frequency emissions from electronic equipment can negatively affect the operation of other electronic equipment causing them to malfunction. Although Cat B25 is designed, tested, and manufactured to comply with regulations governing radio frequency emission in countries such as the United States, Canada, the European Union, and Japan, the wireless transmitters and electrical circuits in Cat B25 may cause interference in other electronic equipment. Therefore, please take the following precautions:

Aircraft: Use of Cat B25 may be prohibited while traveling in aircraft. For more information about using Airplane Mode to turn off the Cat B25 wireless transmitters, see the Cat B25 User Guide.

Vehicles: Radio frequency emissions from Cat B25 may affect electronic systems in motor vehicles. Check with the manufacturer or its representative regarding your vehicle.

Pacemakers: The Health Industry Manufacturers Association recommends that a minimum separation of 15 cm (6 inches) be maintained between a handheld wireless phone and a pacemaker to avoid potential interference with the pacemaker. Persons with pacemakers:

- Should always keep Cat B25 more than 15 cm (6 inches) from the pacemaker when the phone is turned on
- Should not carry Cat B25 in a breast pocket
- Should use the ear opposite the pacemaker to minimize the potential for interference

If you have any reason to suspect that interference is taking place, turn Cat B25 off immediately. (Press and hold the Sleep/Wake button until the red slider appears, then drag the slider.)

Hearing Aids: Cat B25 may interfere with hearing aids. If it does, consult the hearing aid manufacturer or your physician for alternatives or remedies.

Other Medical Devices: If you use any other personal medical device, consult the device manufacturer or your physician to determine if it is adequately shielded from radio frequency emissions from Cat B25.

Health Care Facilities: Hospitals and health care facilities may use equipment that is particularly sensitive to external radio frequency emissions. Turn Cat B25 off when staff or posted signs instruct you to do so.

Blasting Areas and Posted Facilities: To avoid interfering with blasting operations, turn off Cat B25 when in a "blasting area" or in areas posted "Turn off two-way radio." Obey all signs and instructions.

Declaration of Conformity (Radio and Telecommunications Terminal Equipment)

DoC Number: BML/CB25

Certifying Organization:

Bullitt Group No. 4, The Aquarium, King Street Reading RG1 2AN United Kingdom

Product Description:

Mobile Phone + charger supporting GSM 850/900/1800/1900, Bluetooth

Type Name: B25

Market Model Name: Cat B25

We, Bullitt Mobile Limited, declare under our sole responsibility that the above named product(s) conform(s) to all of the essential requirements of the European Union Directive 1999/5/EC Radio & Telecommunications Terminal Equipment (R& TIE). The conformity assessment procedure referred to in Article 10 and detailed in Annex V of Directive 1999/5/EC has been followed and performed with the involvement of a Notified Body:

EMCCert DR. RASEK GmbH, Stoernhofer Berg 15, 91364 Unterleinleiter, Germany

CE 0678

The product is in conformity with the following standards and/ or other normative documents:

SAFETY 3.1.a:

EN 50360:2001 EN 60950-1:2006/A11:2009

EMC 31.b

EN 301 489-1 V1.8.1 EN 301 489-17 V2.1.1 EN 301 489-7 V1.3.1
--

SPECTRUM 3.2

EN 301 511 V9.0.2 EN 300 328 V1.7.1
--

The Technical Construction File (TCF), relevant to the product described above and which support this DoC, are kept at the Certifying Organization stated above.

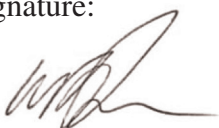
Name: W Drew	Signature: 	Title: Product Manager	Issue Date: 2012-04-03	Last Revised:
-----------------	---	------------------------------	---------------------------	---------------

